



Oak Hill Parkway

A Project 30+ Years in the Making

**Stakeholder Meeting
with Granada Hills HOA**

Via Microsoft Teams
November 10, 2021





Help Slow the Spread of COVID-19



Protect your health.

HHS.gov



**GENERAL ENGINEERING
CONSULTANT**

ATKINS

Member of the SNC-Lavalin Group





- **Project overview**
- **Design**
- **Construction update**
- **Q&A**

For a copy of the presentation, please put your email address in the Microsoft Teams chat or send us a request here:

www.oakhillparkway.com/contact



Project Overview

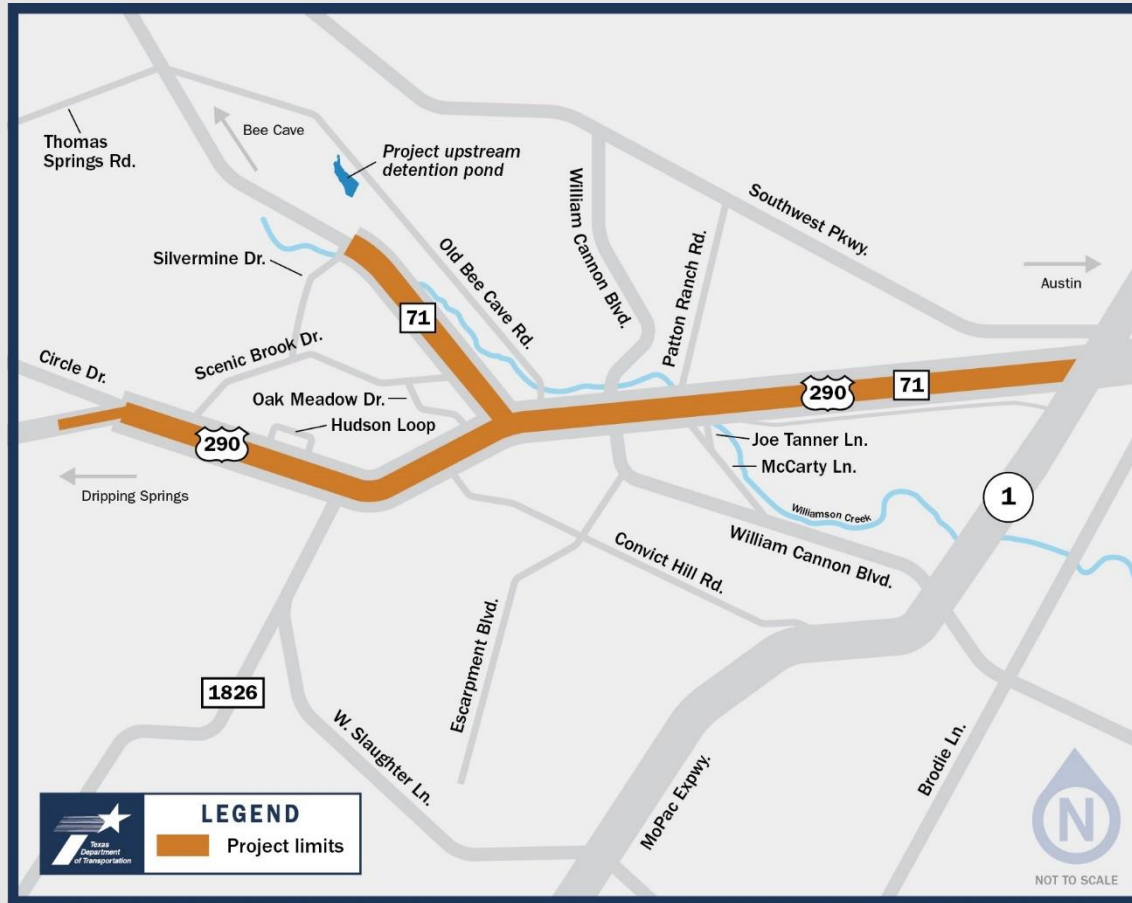

PROJECT LIMITS:

US 290

From MoPac
to Circle Drive

SH 71

From US 290 to
Silvermine Drive

LENGTH: Approximately **7 miles**

LOCATION: **Austin, Travis County**

The intersection of US 290 and SH 71 has long been identified as a heavily congested intersection in need of solutions and is listed in the **100 Most Congested Roadways in Texas**

(Texas A&M Transportation Institute, 2020)

1988	Original environmental clearance
1990s-2000s	Various iterations of the project were considered
2012	Environmental Impact Statement launched
2014-2015	Interim intersection improvements open to traffic
2018	Recent environmental clearance
2020	Design-Build contract awarded
2021	Construction begins

**Oak Hill Parkway
is fully funded as
a non-tolled project**



Construction

2021-2026

**Design-Build
Contractor**

Colorado River Constructors (CRC)
(Fluor-Balfour Beatty JV)

6 miles of roadway
improvements along US 290

Full reconstruction of the
US 290/SH 71 “Y” interchange
to include two new flyovers

New cross street configurations
of US 290 at Convict Hill Rd,
RM 1826, Scenic Brook Dr, and
Circle Dr/South View Rd

1.2 miles of roadway
improvements along SH 71



14 miles of shared-use path
and 1.5 miles of sidewalks



US 290
WESTBOUND



**US 290
WESTBOUND**

DESIGN AS SHOWN SUBJECT TO MINOR CHANGES



Design

Oak Hill Parkway Project Design

US 290 between Scenic Brook Drive and RM 1826



Yellow: US 290 Mainlanes/Bypass Lanes
Green: US 290 Frontage Roads

Blue: Shared-Use Path
Red: Bridge

SUBJECT TO CHANGE

Nov. 10, 2021

14

Oak Hill Parkway Project Rendering

US 290 at Granada Hills Entrance Looking South



SUBJECT TO CHANGE

Nov. 10, 2021

15

Oak Hill Parkway Project Rendering

US 290 at Granada Hills Entrance Looking South



SUBJECT TO CHANGE

Nov. 10, 2021

16

Oak Hill Parkway Project Design

Location of Candelaria Drive



SCREENSHOT FROM GOOGLE MAPS

Oak Hill Parkway Project Design

Candelaria Drive Realignment

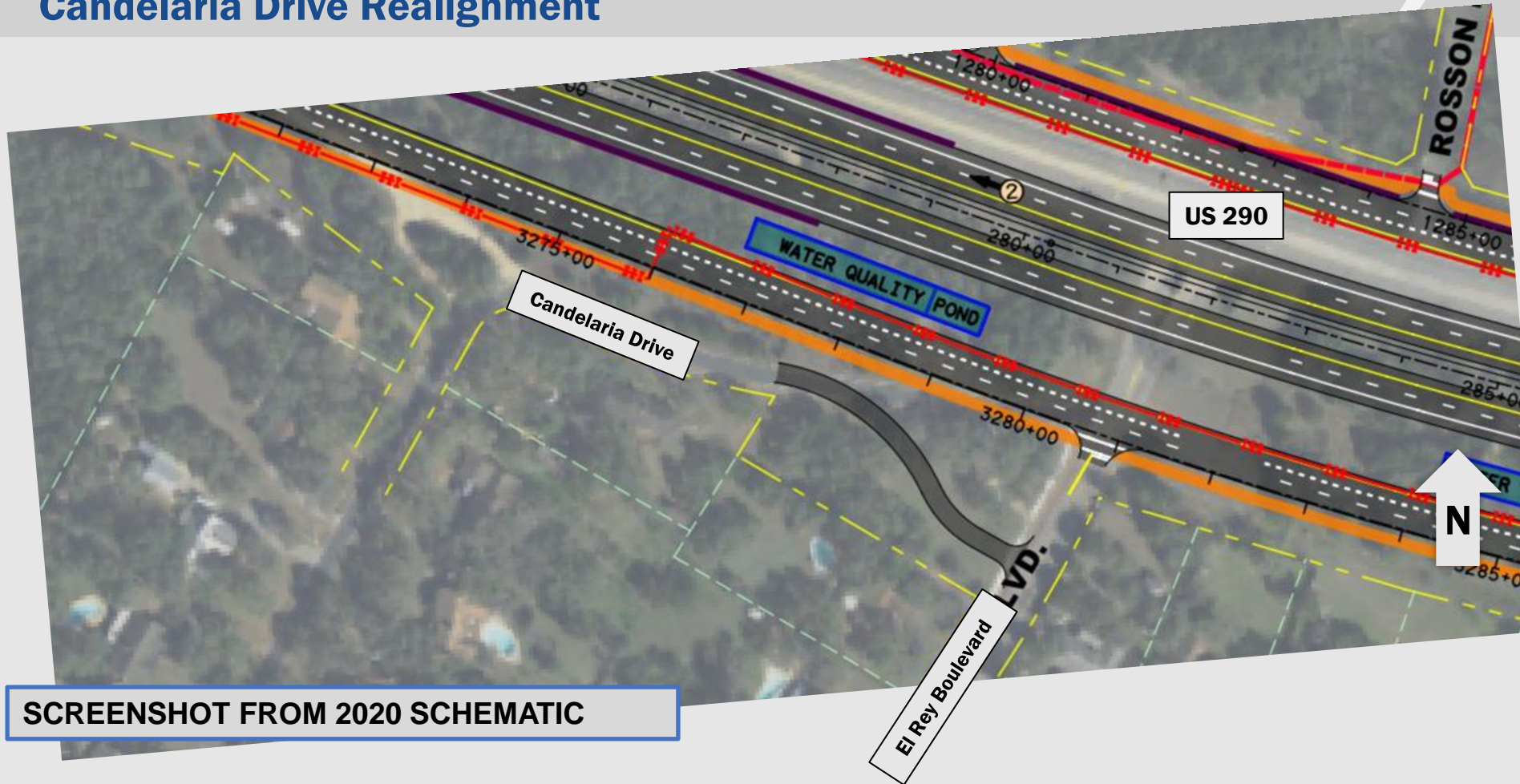

SCREENSHOT FROM 2020 SCHEMATIC

SUBJECT TO CHANGE

Nov. 10, 2021

18

Potential for Adding Landscaping



CURRENT PLAN

- We aim to protect the trees circled in green; subject to change

UNDER CONSIDERATION

- TxDOT is considering additional landscaping at the HOA's request
 - Considerations include space available, how this could impact the existing trees and irrigation needs
 - Feasibility to be evaluated when construction in this area is complete

SCREENSHOT FROM 2020 SCHEMATIC

SUBJECT TO CHANGE

Nov. 10, 2021

19

- Future discussions will occur between the HOA and TxDOT regarding potential location(s) for the neighborhood's replacement front entrance sign and planters
- Agreements with the HOA could occur after construction



SCREENSHOT FROM 2020 SCHEMATIC



Construction Update

**Construction projects can be disruptive,
and we will do our best to be a good neighbor.**

WHAT TO EXPECT:

Travel
delays

Lane shifts,
closures and detours

Shifts in
scheduled activities

Minor changes
to project design

Construction noise,
dust and lighting

Night work

Business access
adjustments

Temporary water/
power shut offs



Rock Trencher

- Expect construction activities that cause **potential noise and dust** to take place during the day, at night and on the weekends for about four years.
- **Nighttime lane closures** on US 290 will generally take place between 9:00 pm and 5:00 am.
- Daytime and nighttime lane closures on **local connecting streets like El Rey Boulevard, RM 1826 and Scenic Brook Drive** may also occur.

What are the contractor's requirements regarding minimizing noise?



- Concrete surfacing and grinding shall only be performed during the day from 7:00 am to 8:00 pm.
- During the hours of 9:00 pm to 5:00 am, the contractor shall utilize a non-intrusive, self-adjusting noise level reverse signal alarm. This requirement does not apply to paving operations (e.g., hot mix and seal coat).
- The contractor will properly maintain machinery and the fit of mufflers for equipment on site.



Rock Milling Machine

TxDOT is committed to the healthy preservation and planting of hundreds of trees in the corridor.

Unique stipulations in the design-build contract include:

- Preservation of several iconic oak trees near US 290 and William Cannon Drive
- Further identification of additional trees for preservation
- Plantings of hundreds of new trees and bushes
- An arborist on the team dedicated to monitor and care for the hundreds of preserved trees in the project corridor



Construction Segments



Anticipated Project Schedule



Late 2020	<ul style="list-style-type: none">▪ Began pre-construction activities
July 2021	<ul style="list-style-type: none">▪ Held groundbreaking ceremony
Late 2021	<ul style="list-style-type: none">▪ Begin utility relocations project-wide▪ Begin work on US 290 West Segment ■▪ Begin work on US 290 East Segment ■
Early 2022	<ul style="list-style-type: none">▪ Begin work on US 290/SH 71 “Y” Interchange Segment ■▪ Begin work on SH 71 Segment ■▪ Begin major lane closures/traffic shifts
2026	<ul style="list-style-type: none">▪ Open to traffic

SUBJECT TO CHANGE

Nov. 10, 2021

27

Construction Activities: Six-Month Lookahead



Clearing & Grading:



Utility Relocations:



Walls:



Frontage Roads:



Bridges:



**Note: No traffic shifts or detours planned in 2021.
Expect traffic changes to begin in 2022.**

SUBJECT TO CHANGE

Construction Sequencing for US 290 West Segment



2022

Traffic stays on existing US 290 while new frontage roads are built.

2023

Traffic moves to new frontage roads while US 290 cross-street bridges are built.

2024

Traffic stays on frontage roads while US 290 mainlanes are built.

2025

Traffic moves to final configuration.



SUBJECT TO CHANGE

Nov. 10, 2021

29

Two-way traffic will be used on new frontage roads during certain phases of construction to maintain access

Example: Between El Rey Boulevard and RM 1826 for Seton Hospital



Access to El Rey Boulevard will be maintained.

Signage will be provided if
changes in access take place.

Lane shifts, closures and detours should be expected.

Updates and public-friendly
maps will be provided in
advance.



Candelaria Drive Realignment

2022

- During utility relocations:
 - Lane closures to be expected
 - No major detour or long-term closure planned
- After utility relocations:
 - Realignment will be built off road
 - Lane closures and potential overnight full closures to be expected when the team ties in old road to the new road



NOTABLE ANTICIPATED ACTIVITY IN 2023

- US 290 eastbound mainlane traffic will move to new US 290 eastbound frontage roads.
 - El Rey Boulevard becomes a permanent right in/right out.
- Temporary cross-street closures for bridge construction over US 290 at **RM 1826** and **Scenic Brook Drive**.
 - Drivers will use **temporary turnarounds or the next available intersection** to cross US 290 during closure.



October 2021 Aerial Shot of US 290
at El Rey Boulevard



2021

- Tree clearing completed
- Grading, rock milling and hauling ongoing
- Drainage system/pond construction ongoing
- Utility relocations ongoing
- Rock trenching to begin

2022

- Grading, rock milling and hauling continues
- Rock trenching continues
- Drainage system/pond construction continues
- Utility relocations continues
- Frontage road construction begins
- Traffic shifts on El Rey Boulevard begins
- Candelaria realignment construction begins



Communications

- **Proactively inform** the community about project
- **Make personal contact** and build relationships
- Listen, acknowledge, and **respond promptly to issues**
- **Mitigate problems** whenever possible
- Implement **in person and online communication methods***
- Leverage **on-road technology**

*METHODS INCLUDE			
Hotline	Website	Twitter	Email alerts
E-newsletter	Direct mail	VMS signs	Blockwalking
Media outreach	Stakeholder meetings	Virtual & In-Person Presentations	Neighborhood events



www.oakhillparkway.com



Twitter: @oakhillparkway



Project Hotline: 512-342-3344

- **VISIT** OakHillParkway.com
- **FOLLOW** @OakHillParkway
- **SIGN UP FOR UPDATES**
 - Weekly Lane Closure E-Blasts
 - Quarterly E-Newsletters
- **CONTACT US** at 512-342-3344 or at www.oakhillparkway.com/contact

For a copy of the presentation, please put your email address in the Microsoft Teams chat or send us a request here: www.oakhillparkway.com/contact



Questions?



www.oakhillparkway.com



Twitter: @oakhillparkway



Project Hotline: 512-342-3344